

P3101-ARMU/P3101-SBMU/P3101-SDMU

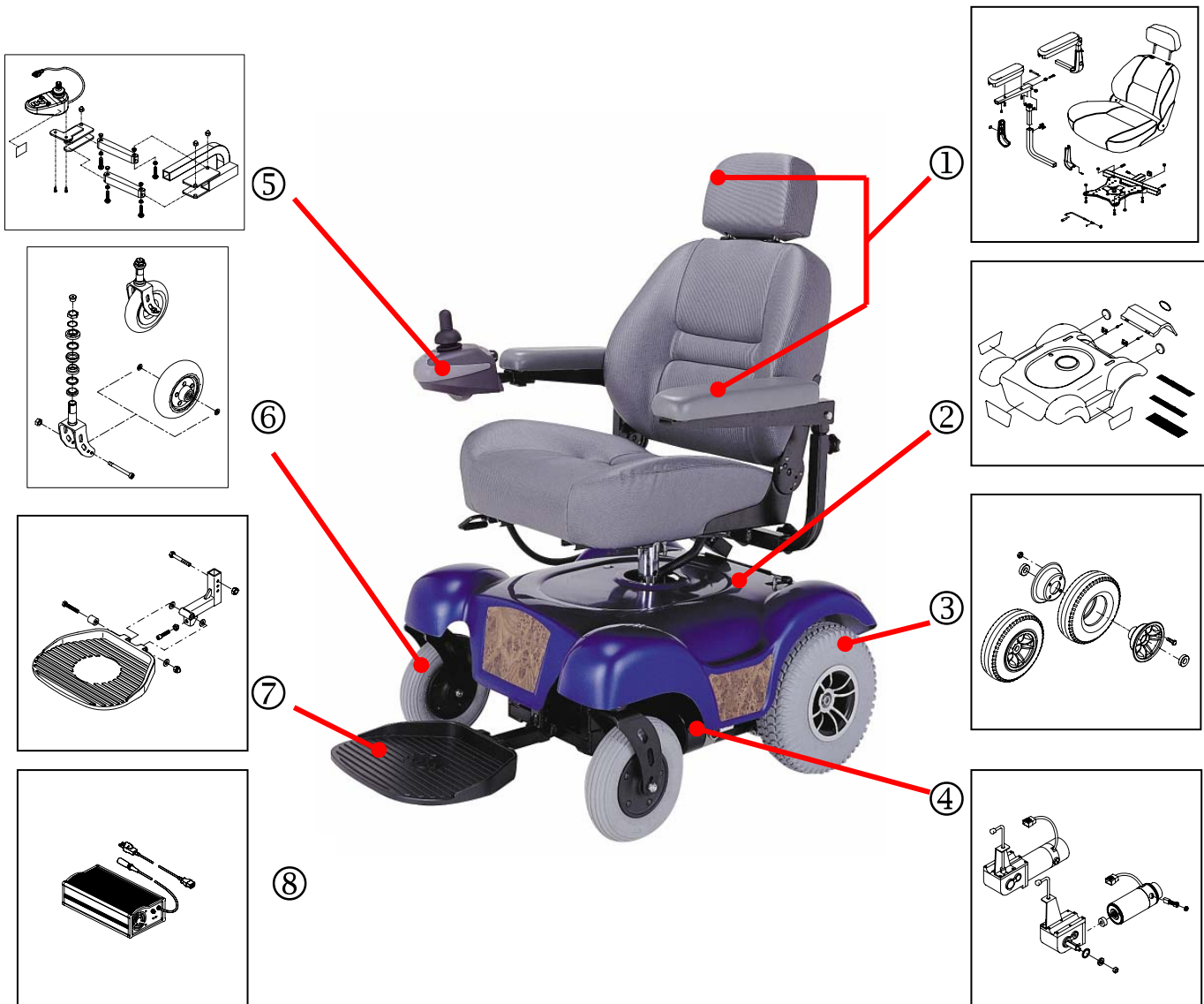

①	Seat ass'y 32200220 (CAPTAIN SEAT ASS'Y) 32222098 (Captain Seat Only,20.5w*18d*20h Dark Gray) 43701072(PAD, ARMREST(LONG),BLACK) 43701073(PAD,ARMREST(SHORT),BLACK)	62120074 (MOTOR, M1CM/N, RH) 62410027 (GEARBOX ONLY,LH,MP3C) 62420027 (GEARBOX ONLY,RH, MP3C)
②	Shroud ass'y 30510840 (Shroud ass'y/ Applered) 30515936 (Shroud ass'y/ Blue) 30552058 (Shroud ass'y/ Black)	⑤
③	Rear wheel ass'y. 32600431(REAR WHEEL ASS'Y)	Controller 33703053 (Joystick ass'y.,VR2, Swing-out Bracket) 64820002 (JOYSTICK ONLY, P&G VR2,JSM D50677) 64220006 (CONTROLLER ONLY,PG VR2-50/D50950)
④	Motor and gearbox complete, LH and RH. 62010129(Motor & Gearbox Ass'y.,M13CM-4, LH) 62020129(Motor & Gearbox Ass'y.,M13CM-4, RH) 62110074 (MOTOR, M1CM/N, LH)	⑥
		Caster Wheel with Fork Ass'y. 33100632 (200*50PU Caster Wheel ass'y.,W/Fork ,LH/RH)
		⑦
		Footplate ass'y. 33303037(ALUM. FOOTPLATE&BRACKETASS'Y.)
		⑧
		Charger unit 65142005 (CHARGER, HP8204-5A-OFF) 63600008 (CHARGER POWERCORD W/PLUG,US SPEC)