

P30111ARMU/P30111SBMU/P30111SDMU

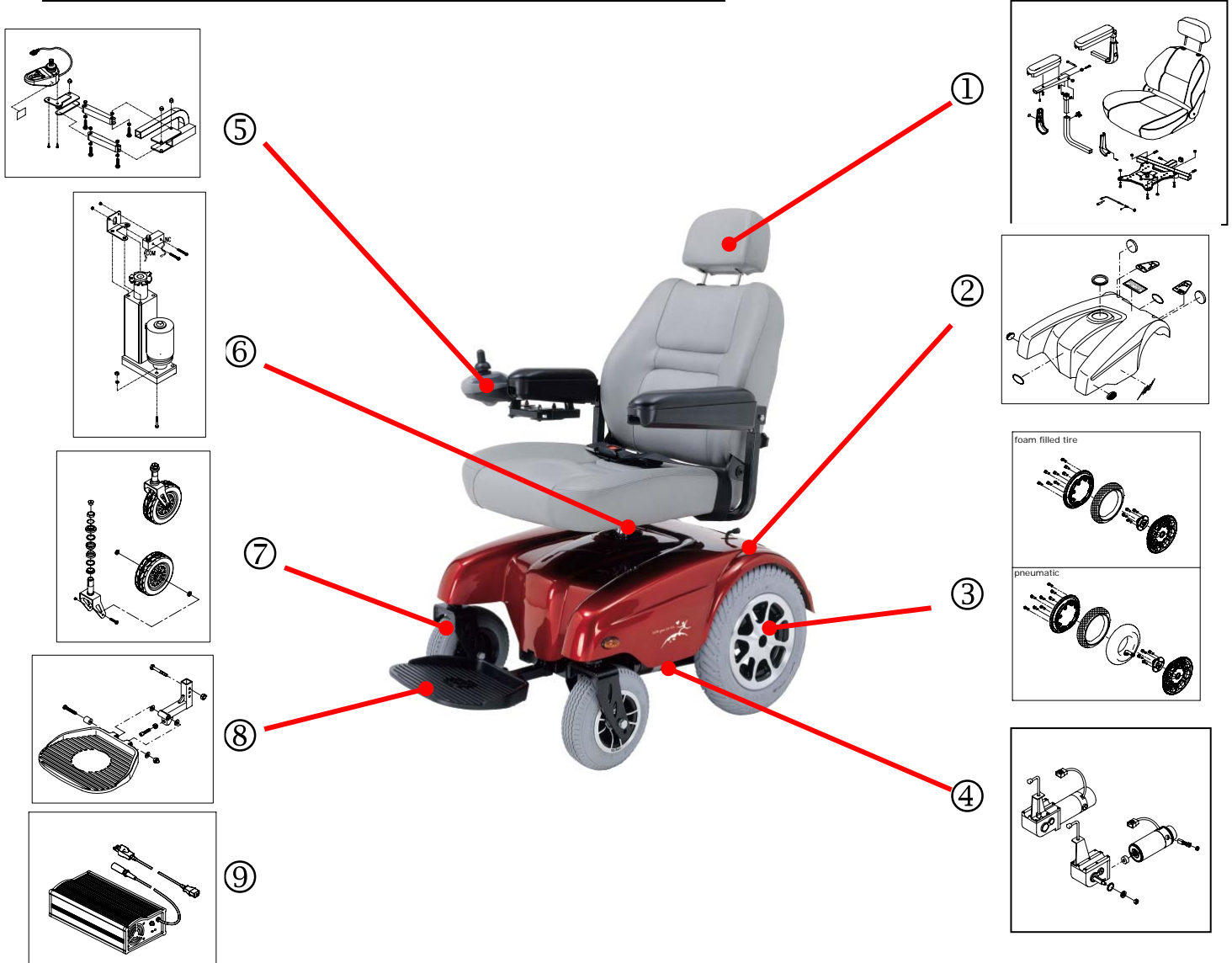

①	Seat ass'y 32200173 (Captain Seat ass'y) 32222085 (Captain Seat Only,Color,2tone,20.5w*18d*20h) 43701072(PAD, ARMREST(LONG),BLACK) 43701073(PAD,ARMREST(SHORT),BLACK)	62120076 (MOTOR, MIDG/H, RH) 62410025 (GEARBOX ONLY, M12-11, LH) 62420025 (GEARBOX ONLY, M12-11, RH)
②	Shroud ass'y 30510838 (SHROUD ASS'Y(CANDY APPLE RED)) 30515934 (SHROUD ASS'Y(BLUE)) 30552057 (SHROUD ASS'Y(BLACK))	⑤
③	Rear wheel ass'y. 32600204 (DRIVE WHEEL ASS'Y,LH3.00-8 C917 PU) 32600205 (DRIVE WHEEL ASS'Y,RH3.00-8 C917 PU)	Controller 33703054(JOYSTICK BRACKET ASS'Y,VR2 SEAT LIFT.) 64820001 (JOYSTICK ONLY, P&G VR2,JSM-A(D50680)) 64220005(CONTROLLER ONLY,PG VR2-60-A1(D50682.))
④	Motor and gearbox complete, LH and RH. 62010098 (MOTOR & GEARBOX, LH,M12DG-11) 62020098 (MOTOR & GEARBOX, RH,M12DG-11) 62110076 (MOTOR, MIDG/H, LH)	⑥
		Seat lift ass'y 62100078(LIFTING MOTOR ASS'Y(P301))
		⑦
		Caster Wheel with Fork Ass'y. 33100634 (FRONT WHEEL ASSY., GRAY,2.80/2.50-4 PU)
		⑧
		Footplate ass'y. 33303037 (ALUM. FOOTPLATE&BRACKETASS'Y.)
		⑨
		Charger unit 65142005 (CHARGER, HP8204-5A-OFF) 63600008 (CHARGER POWERCORD W/PLUG,US SPEC)